

PROPOSED G + IV STORIED RESIDENTIAL BUILDING AT PREMISES NO. 816, MOTILAL GUPTA ROAD, WARD NO. - 122, BOROUGH - XIII, ASSESSEE NO. - 41-122-08-0946-1, P.O. & P.S. - HARIDEVPUR. WITHIN THE LIMITS OF THE KOLKATA MUNICIPAL CORPORATION, KOLKATA - 700082.

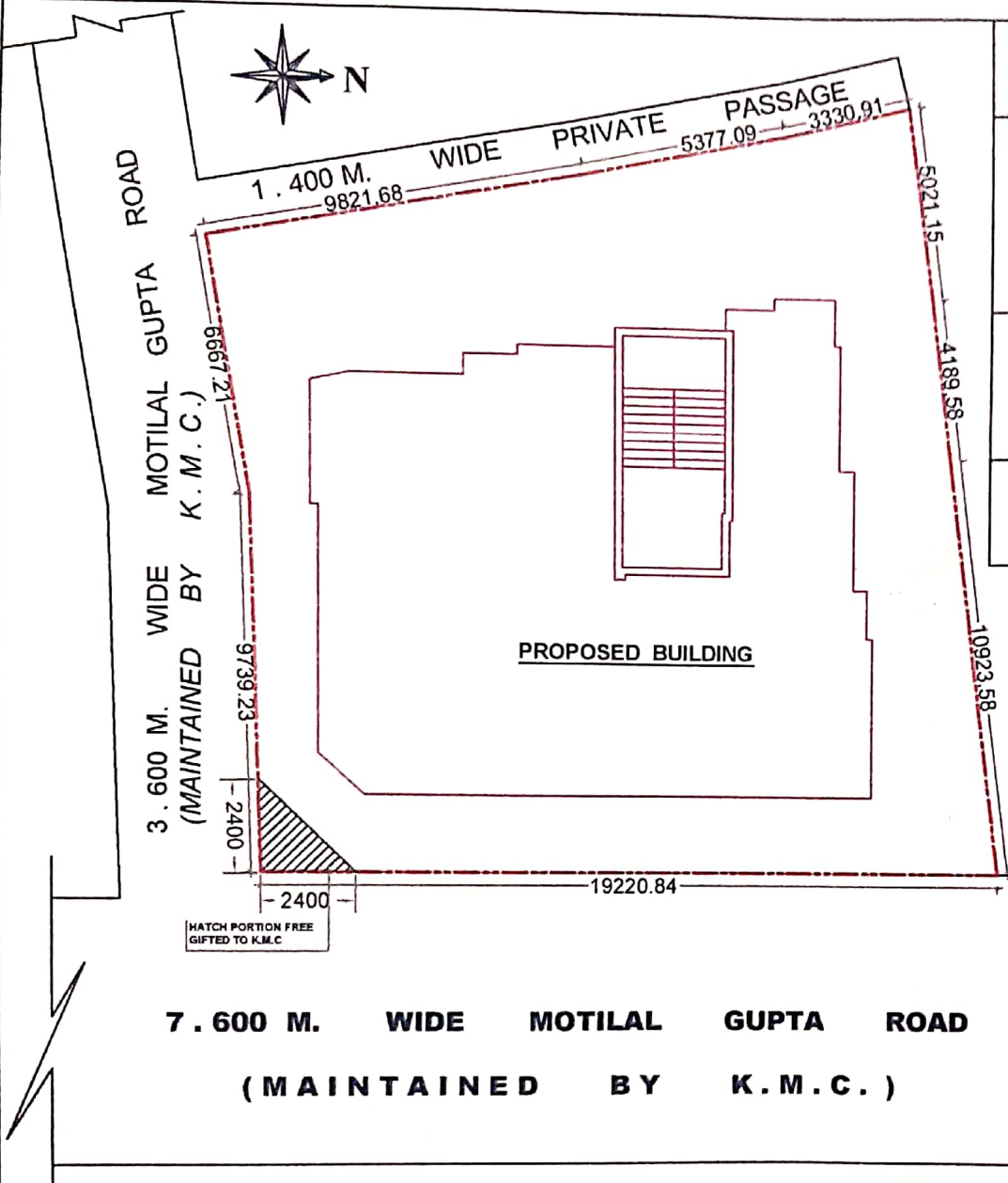

LAND AREA AS PER DEED	337.699 SQM
LAND AREA AS PER PHYSICAL MEASUREMENT	337.129 SQM
MKD.	<input type="text"/>
TOTAL COVERED AREA	828.935 SQM.
MKD.	<input type="text"/>
HEIGHT OF THE BUILDING	15.50 M.

LATITUDE	LONGITUDE
22° 29' 04.9"N	88° 19' 49.2"E

GROUND FLOOR PLAN

SCALE = 1:200

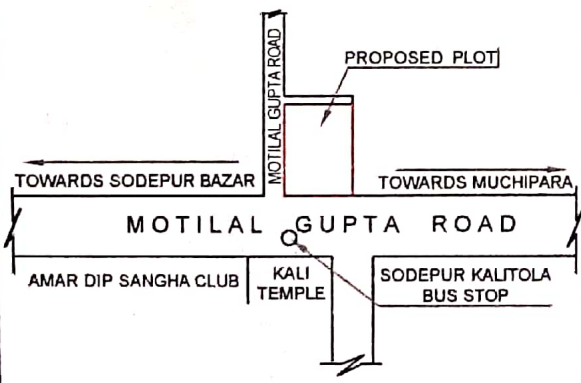

LOCATION PLAN
SCALE - N.T.S.

Gautam Bhattacharya
SIGNATURE OF OWNER / S

SRI GAUTAM BHATTACHARYA,
 PROP. OF NILIMA CONSTRUCTION
 CONSTITUTE ATTORNEY OF I. DR. SWAPAN
 KR. DATTA, II. SMT. TANDRA ROY, III. SMT.
 PRATIMA DATTA, IV. SMT. RATNA K. KUMAR,
 V. SRI. SUSHANT KR. DATTA.

Anurag Bhattacharyya
SIGNATURE OF L.B.S. / A.

ANURAG BHATTACHARYYA
 ENGINEER, B. TECH - CIVIL, (AMIE-1720883)
 L.B.S. - CLASS-I, REG. NO.- 1528
 THE KOLKATA MUNICIPAL CORPORATION
 Mob.- 9830073782
ANURAG BHATTACHARYYA
 L.B.S / 1 / 528